



Jerry's Weed StickTM

Handheld Weed Sprayer



Model #DKJW-88

OWNERS MANUAL

PLEASE READ THIS MANUAL CAREFULLY BEFORE USING

WARNING AND CAUTIONS	2
PRODUCT DESCRIPTIONS	3
PRODUCT COMPONENTS	3
INSTALLATION INSTRUCTIONS	4
OPERATING INSTRUCTIONS	5
MAINTENANCE INSTRUCTIONS	5
STORAGE AND DISPOSAL	6
FIRST AID STATEMENTS	6
DK PRODUCTS LIMITED WARRANTY	7

WARNING!

DO NOT USE ANY FLAMMABLES IN THIS SPRAYER as it is not designed nor intended for such use. Some spray materials can ignite or explode. Do not spray in an enclosed space, near an open flame such as found in a BBQ grill or water heater, near an electric motor or open switch, or any source of heat. **DO NOT SMOKE** while spraying. Use of flammables could result in **SERIOUS INJURY** or **PROPERTY DAMAGE**

DO NOT USE ANY CAUSTICSS OR ACIDS IN THIS SPRAYER since these can damage or weaken the sprayer and its parts, resulting in **SERIOUS INJURY** or **PROPERTY DAMAGE** from unintended use.

CAUTION!

- Before using any pesticides or any other spray material in your sprayer, **READ THE LABEL ON THE SPRAY MATERIAL CONTAINER AND FOLLOW THE INSTRUCTIONS FOR MIXING AND USE INCLUDING WEARING PROTECTIVE CLOTHING**. Some spray materials are dangerous and should not be used in this sprayer as the can damage the sprayer or its parts, or may be harmful to the user. This could result in **SERIOUS BODILY INJURY** or **PROPERTY DAMAGE**.
- **DO NOT** use hot or boiling liquids in sprayer since this may weaken or damage tank or pump.
- **DO NOT PRESSURIZE WITH ANY MECHANICAL DEVICE** such as an air compressor, as this could result in **SERIOUS INJURY**
- **DO** use sprayer with head or body over pump or sprayer nozzle
- **DO not** smoke or eat while mixing spray materials or spraying chemical, and always wash and cleanup afterwards.
- Empty, clean and drain sprayer tank after each use according to directions.
- When cleaning, do not pour washwater on the ground; spray or drain over a large area away from wells and other water sources.

Spraying Tips

- Always read and carefully follow chemical label directions
- Carefully mix spray solutions in a separate container and strain through fine cheesecloth or household strainer to remove particles when transferring to sprayer
- Wear Protective clothing such as goggles, face mask, long sleeves, long pants, gloves etc. to prevent contact with the chemicals
- Always tighten cap after filling tank
- Always use caution when operating this device

PRODUCT DESCRIPTIONS

Jerry's Weed Stick is a superior lawn and garden tool. It is a dual-purpose trigger-activated spot sprayer for conservative dispensing of herbicide, pesticide and dye marking for the control of unwanted weeds and bugs. Jerry's Weed Stick is a lightweight, hand held ergonomic device requiring no bending or stooping associated with common back pain. The unique cup design surrounding the spray nozzle targets the area, while eliminating drifting of herbicide onto desirable flowers, ground cover and grass. A squeeze of the trigger dispenses the desirable amount of spray to kill targeted weeds or bugs. The Weed Stick is a easy to use product as it weights only 2 lbs and holds 2 lb of chemical for a total weight of 4 lbs. Used properly the WeedStick can reduce the amount of chemicals used by up to 85% of expensive products as it dispenses just 3 ccs of with each squeeze of the trigger, in comparison to as much as 24 ccs by common pressurized sprayers. When used properly, Jerry's Weed Stick can provide up to 450 applications per filling.

PRODUCT COMPONENTS

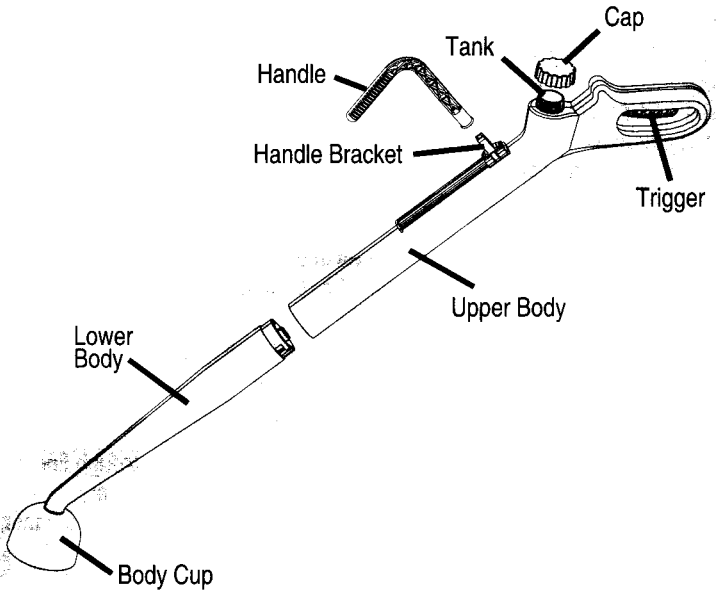

INSTALLATION INSTRUCTIONS

1. Assembling your Weed Stick

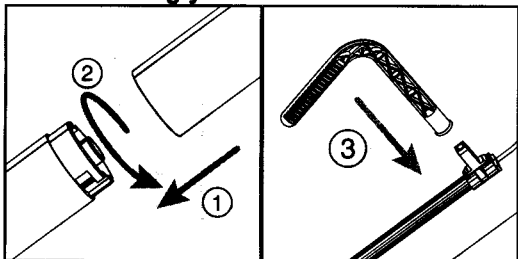

1. Insert Lower Body to the Upper Body.
2. Twist the Lower Body as shown to a locked position.
3. Insert the Handle to the Handle Bracket.

2. FILLING YOUR SPRAYER:

- BEFORE FILLING, BE SURE TO READ, UNDERSTAND AND FOLLOW EXACTLY THE LABEL INSTRUCTIONS ON SPRAY MATERIAL CONTAINER!
- ALWAYS PREMIX ANY POWDERED CHEMICALS OR CONCENTRATES IN ANOTHER CONTAINER TO ENSURE THAT ALL MATERIALS ARE MIXED AND COMPLETELY DISSOLVED.

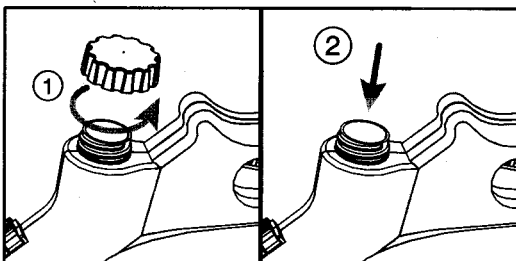

1. Unscrew and remove the Cap.
2. Pour in the pre-measured amount** of chemicals into the tank. During filling, always keep the tank in vertical position.
3. Place back the Cap and tighten.

Note: **To avoid the problem of excess mixture, carefully calculate and measure the amount of chemicals required for the application. If all chemicals are not used, these chemicals should be disposed of according to the instructions provided by the manufacturer of the chemical product.

Please note that some pesticides may become less effective after they are opened or mixed. Follow storage directions on the chemical label for specific or special requirements to prevent degradation, contamination, and accidental exposure.

OPERATING INSTRUCTIONS

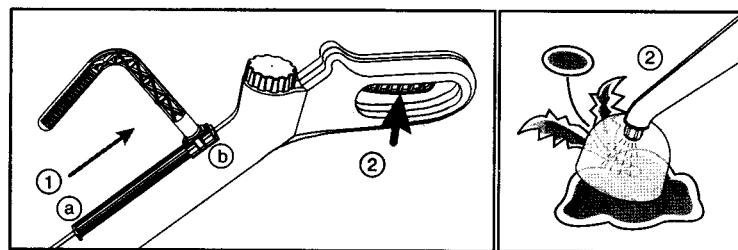

1. Adjust the handle to a convenient position by squeezing the tabs and sliding it up or down between a and b.
2. WeedStick is equipped with a transparent Cup. Position the Cup directly over the weed you to desire to kill and squeeze the trigger to apply the chemical.

Note:

- Apply herbicide regularly to keep weeds under control according to the manufacturers instructions.
- Please see chemical manufacturers applications recommendations for the best time for applying chemicals in your region.

MAINTENANCE INSTRUCTIONS

1. Clean and dry your sprayer after every use to prolong its useful life. Spray materials should not be left in the sprayer as they may harden and plug the nozzle.
2. Once the unit is assembled out of the box, it should remain assembled to reduce the possibility of accidental leaks or spills of chemicals.
3. Dismantling of the WEEDSTICK will void any warranty and eliminate any liability by the manufacturer. There are no serviceable or replacement parts available for this product.

STORAGE AND DISPOSAL

Excess herbicide or pesticide should not be stored in the WeedStick. Improper storage Disposal or removal may be hazardous to human health and the environment. Please follow these safety recommendations:

Storage

1. Don't stockpile chemicals. Reduce storage needs by buying only the amount of herbicide or pesticide that you will need in the near future or during the current season when the pest is active.
2. Follow all storage instructions on the pesticide label.
3. Store WeedStick out of reach of children and pets. It is recommended to keep it in a locked cabinet in a well-ventilated utility area or garden shed.
4. Never store in cabinets with or near food, animal feed, or medical supplies.
5. Transfer pesticide label to the WeedStick body, which includes the listing ingredients, directions for use, and first aid steps in case of accidental poisoning.
6. Do not store WeedStick in places where flooding is possible or in places where they might spill or leak into wells, drains, ground water, or surface water.

Disposal

1. The best way to dispose of small amounts of excess pesticides is to use them - apply them according to the directions on the label.
2. Dispose of chemical containers per the manufacturers instructions.
3. For partly filled chemical containers with unused chemicals, call your local solid waste agency or 1-800-CLEANUP for disposal instructions. Do not pour leftover pesticides down the sink, into the toilet, or down a sewer or street drain. Pesticides may interfere with the operation of wastewater treatment systems or pollute waterways.
4. State and local laws regarding pesticide disposal may be stricter than the Federal requirements on the label. Be sure to check with your state or local agencies before disposing of your pesticide containers.

FIRST AID STATEMENTS

1. Always keep the Direction Label on the original container or package. Follow the FIRST AID directions there.
2. For emergency, call the National Poison Center Number 1-800-222-1222.

NOTICE TO USER: Buyer assumes all risks of use, storage or handling of this product not in accordance with directions.

DK PRODUCTS LIMITED WARRANTY

Duration of this warranty

Jerry's Weed Stick 1 Year

DK Products warrants to the original consumer purchaser of this product at retail that it is free from problems in materials and workmanship for the period specified above from the original date of purchase. The warranty does not apply to damage to the product resulting from accident, misuse, neglect, alteration, modification, tampering, or failure to follow instructions supplied with the product. This warranty does not cover normal wear and tear of o-rings or seals. The warranty shall be void if the product is used commercially.

If the product or any part of it should malfunction within the warranty period, telephone our CUSTOMER SERVICE DEPARTMENT or call 1-414-607-9681 for fast service. We will at our option, repair or replace the unit. We retain the option of requiring the prepaid return of the product along with proof of purchase to DK Products, LLC 10600 West Mitchell Street, Milwaukee, WI 53214.

This warranty is only valid in North America

You must retain your sales receipt as proof of the date of purchase and included it with any return of product.

ANY IMPLIED WARRANTIES, INCLUDING ANY IMPLIED WARRANTY OF MERCHANTABILITY OR FITNESS FOR CONSUMER USE, ARE LIMITED TO 1 YEAR. DK PRODUCTS LLC, EXCLUDES LIABILITY UNDER THIS WARRANTY FOR ANY AND ALL INCIDENTAL AND CONSEQUENTIAL LOSS OR DAMAGES.

DK PRODUCTS, LLC
10600 West Mitchell Street
West Allis, WI 53214
Phone: 1-414-607-9681
Email: info@dkproducts.biz
www.dkproducts.biz

Made in China
Copyright 2008