

List of Available Spare Parts:

- No. 30 Set of Gaskets and O-Rings
- No. 28 Screws (2)
- No. 27 1.5 liter Bottle, P-50
- No. 26 Filter
- No. 25 Suction Tube
- No. 24 Bottle Seal
- No. 23 Valve Screw Cap
- No. 22 Valve Spring
- No. 21 Valve Plunger
- No. 20 Pump Cylinder
- No. 19 O-Ring 3 x 2.7
- No. 18 Plunger O-Ring
- No. 17 Plunger
- No. 16 Plastic Valve Ball
- No. 15 Pressure Spring 4-Bar
- No. 14 Pump Handle Guide
- No. 13/12 Pump Handle with Cover Lid
- No. 11/10 Nozzle/Brass Insert 8mm Bore
- No. 9 Swirl Piece P-50
- No. 8 Gasket
- No. 7 Clip
- No. 6 Trigger
- No. 5 Swirl Cone
- No. 4 Swirl Cone Spring
- No. 3 Retaining Disk
- No. 2 O-Ring 5 x 1.5 (3x)
- No. 1 Sprayer Casing

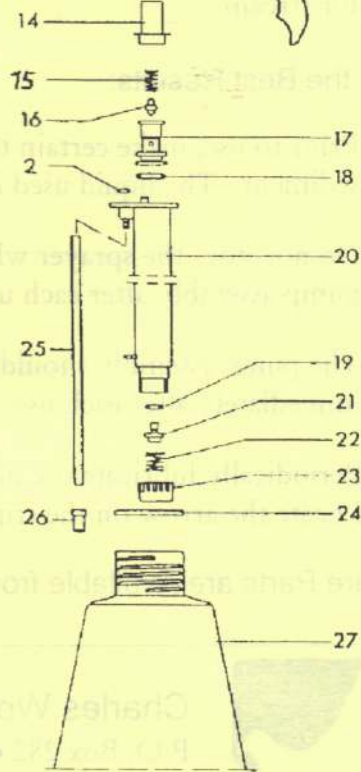

HIGH PRECISION COMPRESSION SPRAYER P-50

Suggested Use:

In order to build up sufficient pressure in your sprayer, it is essential to have an airtight seal. Be sure to screw the pump assembly closed tightly.

1. Fill the bottle no higher than the level indicated as „MAX“.
2. Close the pump assembly tightly.
3. Pump the handle 30 to 40 times to build up sufficient pressure.
4. Pull the trigger and adjust the nozzle to the desired type of spray. Turn the nozzle to the left for fine mist or to the right for stream.

For the Best Results:

1. Prior to use, make certain that the nozzle and filter are free from sediment. The liquid used in the bottle needs to be free of solids.
2. Do not store the sprayer while it is pressurized. Loosen the pump assembly after each use to release the pressure.
3. The pump assembly should be rinsed with clear water immediately after each use.
4. Periodically lubricate the plunger with a few drops of oil. Locate the arrow on the trigger to find the oil reservoir.

Spare Parts are Available from Your Supplier.



Charles Wolfe & Associates, Inc.
P.O. Box 282 • Cumming, Georgia 30028
Tel: (770)889-9299
Fax: (770)781-9589