

73100

Advanced Two-Zone Electronic Water Timer

User Instructions ■ English

73100_INS_ENG_01

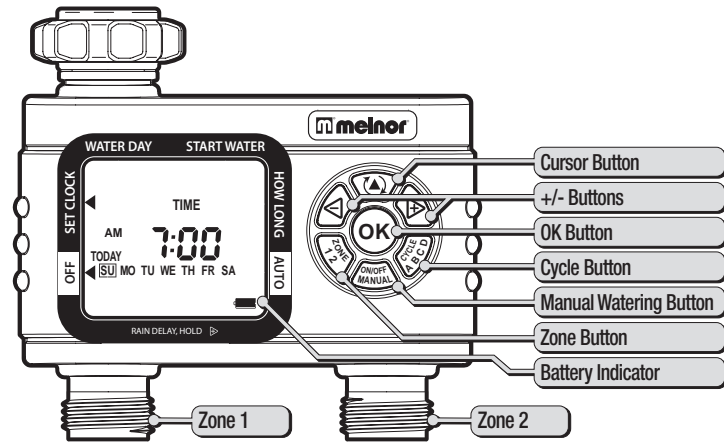

1 Understanding Zones

This is a two zone timer allowing you to water two different areas from the same faucet.

Each zone can be programmed with up to four different start times.

You can use the **PLANNING TABLE** provided on the back of this sheet to help organize your watering schedule for each zone.

2 Battery Installation & Assembly

Remove the battery holder from the back of the **Timer Control Unit**. Insert two AA alkaline batteries (Do not use rechargeable batteries) as indicated on the battery holder. Replace the battery holder, making sure that it is firmly and securely placed in the **Timer Control Unit**.

NOTE: Do not use your timer when the air temperature is below 40°F (4.5° C). When storing your timer, be sure it is in a dry place and protected from frost.

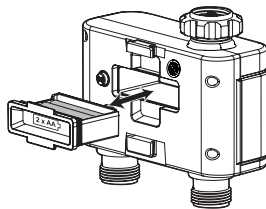

We recommend replacing batteries when the indicator reaches

Installation of the Timer

Attach the timer to an outside faucet and turn on the water. The water must be left on while the timer is attached to the faucet for your timer to operate.

NOTE: You may choose to program your timer before or after attaching it to the faucet.

3 SET CLOCK: "Set Current Time and Day"

The Water Timer default setting is a **12-hour** mode (AM/PM). To ensure correct timing, look for either **AM** or **PM** to the left of the time. To switch between **12-hour** (AM/PM) and **24-hour** (military time), hold the **OK** button for 5 seconds. **12-hour** mode shows AM or PM while **24-hour** mode does not. **NOTE:** Changing time mode will erase all programs.

Before setting your watering times, you must first set the current time and day of the week. When the batteries are first installed, the arrow in the screen will point to **CLOCK**. If it is not in that position, press the **SET CLOCK** button until the arrow is pointing to **CLOCK**.

On your screen, a flashing box will appear around the **SU**. Simply set the timer to the current day by pressing the **LEFT** and **RIGHT** buttons on the touchpad until the square is on the correct day. Once the correct day has been indicated, press the **OK** button.

To set the time, press the **LEFT** and **RIGHT** buttons until the correct time appears on the screen, and then press **OK**.

Press the **SET CLOCK** button (at the top of the touch pad) to move to **WATER DAY**.

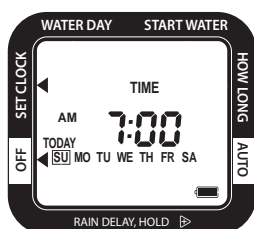

4 WATER DAY: "What days do you want to water?"

Check to be sure that the arrow on the screen is pointing to **WATER DAY**. With this setting, you can select specific days to water or an interval period of the day when watering will occur.

To set the watering day, use the **LEFT** and **RIGHT** buttons to select the day-of-the-week you wish to water. Press the **OK** button when the desired day-of-the-week is highlighted on the screen. You can select as many days as you like. The days selected will have a square around them.

To water at preset intervals, press the **RIGHT** button on the buttonpad to navigate past the days of the week. Press the **LEFT** and **RIGHT** buttons to set the time period (**EVERY 1 DAY** through **EVERY 7 DAY(s)**).

Press the **SET CLOCK** button to move to **START WATER**.

Note: You will see **Zone 1** highlighted at the bottom of the screen; program Zone 1 before moving on to Zone 2.

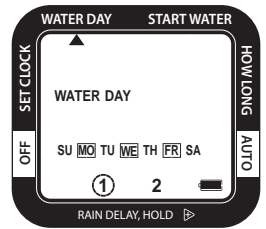

5 START WATER: "What time-of-day do you want to water?"

You can select up to four independent start times (**CYCLE A, B, C, D**). With the arrow pointing to **Start Water** on your screen, **CYCLE A** should be highlighted, use the **LEFT** and **RIGHT** buttons to select the first watering time.

If you want to set another **START WATER** time, press **PREV** to move to **CYCLE B**. Repeat the process above to set the next **START WATER** time. You may select up to four **START WATER** times.

When you have set all desired **START WATER** times, press the **SET CLOCK** button to move to **HOW LONG**.

Hold the **LEFT** or **RIGHT** buttons to advance settings more quickly.

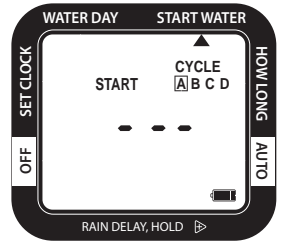

6 HOW LONG: "Set the length of each watering cycle."

With the arrow pointing to **HOW LONG**, use the **LEFT** and **RIGHT** buttons to select the length of each watering cycle. After setting **HOW LONG** you want to water during a selected cycle, press **PREV** to move to the next cycle. Repeat until **HOW LONG** has been set for each cycle.

HOW LONG can be set for up to 360 minutes (6 hours) for each watering cycle. The Cycle length cannot overlap the next **START WATER** time.

Note: You can only select Watering Cycles if you have set a start time in **Step 5** above.

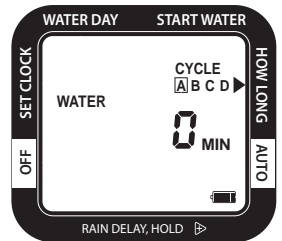

7 SETTING ANOTHER ZONE: "Keep your plants watered on separate cycles."

When you have set **WATER DAY**, **START WATER**, and **HOW LONG** for Zone 1, press the **SET CLOCK** button back to **WATER DAY**.

Press **ZONE** to select Zone 2, and repeat steps 4-6 above.

When all desired zones are set, press the **SET CLOCK** button to enter **AUTO** mode.

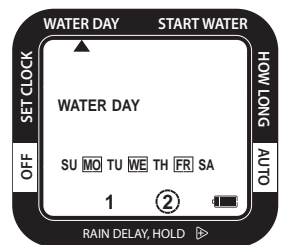

8 AUTO MODE: "Your timer is ready to go."

In **AUTO** Mode, your timer will run the watering program you have entered.

The screen display will alternate between showing the current time and the next watering cycle of each zone.

9 RAIN DELAY: "Prevent watering when rain is in the forecast."

If there is rain in the forecast, you can temporarily suspend your watering program on both zones for up to 7 days using the **RAIN DELAY** feature. After the selected delay has ended, your watering program will automatically resume.

To set the Rain Delay, check to make sure the arrow on the screen is pointing to **AUTO**.

Hold the **PAUSE** button until the word **DELAY** appears. Now press the **PAUSE** button to set the duration of the delay. You can reduce or deactivate the delay period with the **LEFT** button.

Once the delay time is selected, press the **OK** button and wait for the number to stop flashing.

All other functions, including **MANUAL WATERING** and **OFF** are on hold during **RAIN DELAY**. To cancel **RAIN DELAY**, press the **PAUSE** button until **DELAY** is set to "0".

Note: In the **RAIN DELAY** mode, the screen will alternate between the current time and the remaining delay time.

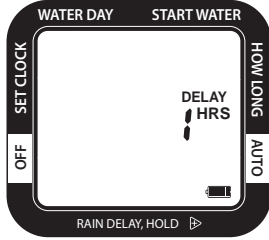

10 OFF MODE: "Stop watering for an extended period."

To stop watering indefinitely, press the **PAUSE** button until the arrow on the screen points to **OFF**. The timer will not water while in this mode. The screen will display the word **OFF**.

To start watering automatically again, press the **PAUSE** button until the arrow on the screen points to the **AUTO**. The program will begin watering at the next previously scheduled **START WATER** Time.

Note: Watering will be stopped for both zones when this feature is activated.

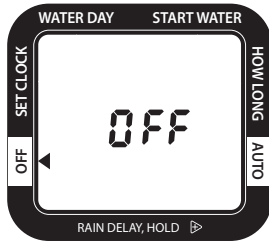

11 MANUAL WATERING: "Fill a bucket, clean the car or wash the dog."

To use a hose or other watering tool, simply press the (manual) button. Then using the **LEFT** button select which zone you want to use.

Using the **RIGHT** button, select the length of time you wish to water. After a few seconds, the valve will open, and then automatically close when the selected time is reached.

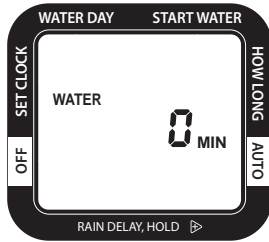

12 TIMER RESET

To completely erase all settings in the timer and return to the original factory settings, press and hold the **OK** button for 7 seconds. The screen will display **RESET**.

You will need to press and hold the **OK** button a second time to change the clock format.

Note: All programming will be lost when the timer is **RESET**. After **RESET** You may need to change the time setting between **12-hour** (AM/PM) and **24-hour** (military time). See **Step 4** for further instructions.

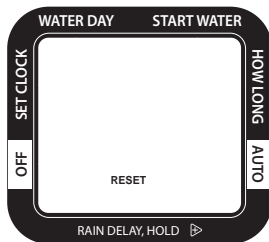

PLANNING TABLE

ZONE 1	CYCLE A	CYCLE B	CYCLE C	CYCLE D
Start Water (Time)				
How Long (Minutes)				
ZONE 2	CYCLE A	CYCLE B	CYCLE C	CYCLE D
Start Water (Time)				
How Long (Minutes)				

USEFUL TIPS

Open Valve During Installation

Shaking during transportation can cause valves to be open. If this occurs, water may run continuously through the valves during installation.

Turn the water off.

Remove the batteries. Wait for the screen to go blank. Reinsert the batteries.

Note: Removing the batteries will not erase any existing watering schedules.

Turn the water back on.

If the problem persists, turn off the water. Use the **Manual** feature to open and close the valves 3 times.

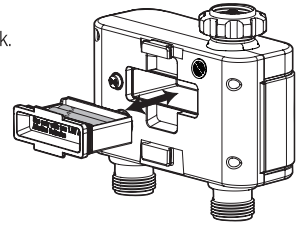

Cleaning Your Timer

You should clean your timer periodically. Debris or sediments commonly found in water can build up in your timer.

Turn off the water. Remove the timer from the faucet and check that the filter washer is clear. If you notice any debris, remove the filter washer and clean it out with water.

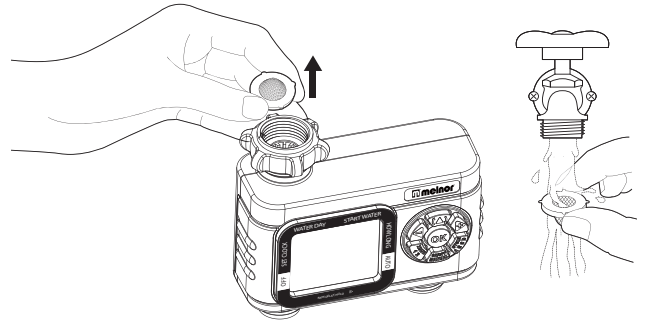

Activate the **MANUAL** mode by pressing the **MANUAL** button. Open the valves and spray water through the valves and the faucet connection to flush out any built-up sediments or debris.

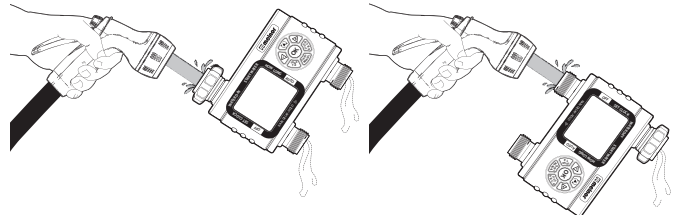

Seasonal Storage

Freezing temperatures can cause water in the timer to freeze and expand, damaging the timer.

At the end of the season or when there is frost in the forecast, turn off the water and remove your timer from the faucet.

Remove the batteries.

Be sure to store the timer indoors, away from freezing temperatures.

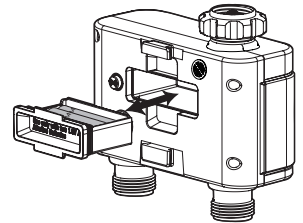

Tips for Battery Life

Make sure to use fresh alkaline batteries.

Do not use rechargeable batteries.

Remove the batteries at the end of the season before storing.

Batteries should last about one season. A schedule with more frequent watering times can cause the batteries to drain faster.

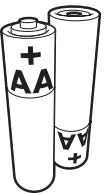

Works with

melnor HydroLogic
Soil Moisture Sensor (not included)

Prevent overwatering while conserving water by connecting your timer to the HydroLogic® Soil Moisture Sensor. The easy to set sensor monitors moisture in the soil, and will suspend a watering cycle when it is raining or when the ground is already wet. Adjust the dial to maintain just the right amount of moisture for healthy lawns and gardens.

Learn more at www.melnor.com

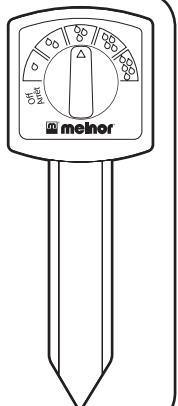

Warning: Intended for outdoor use only. Severe electrical shock could result if water is sprayed into outlets or sources of electrical current. Do not use water more than 115°F (46°C). Do not use when the ambient air temperature is less 40°F (4.5°C). When not in use, remove batteries, drain and store indoors away from freezing temperatures.