

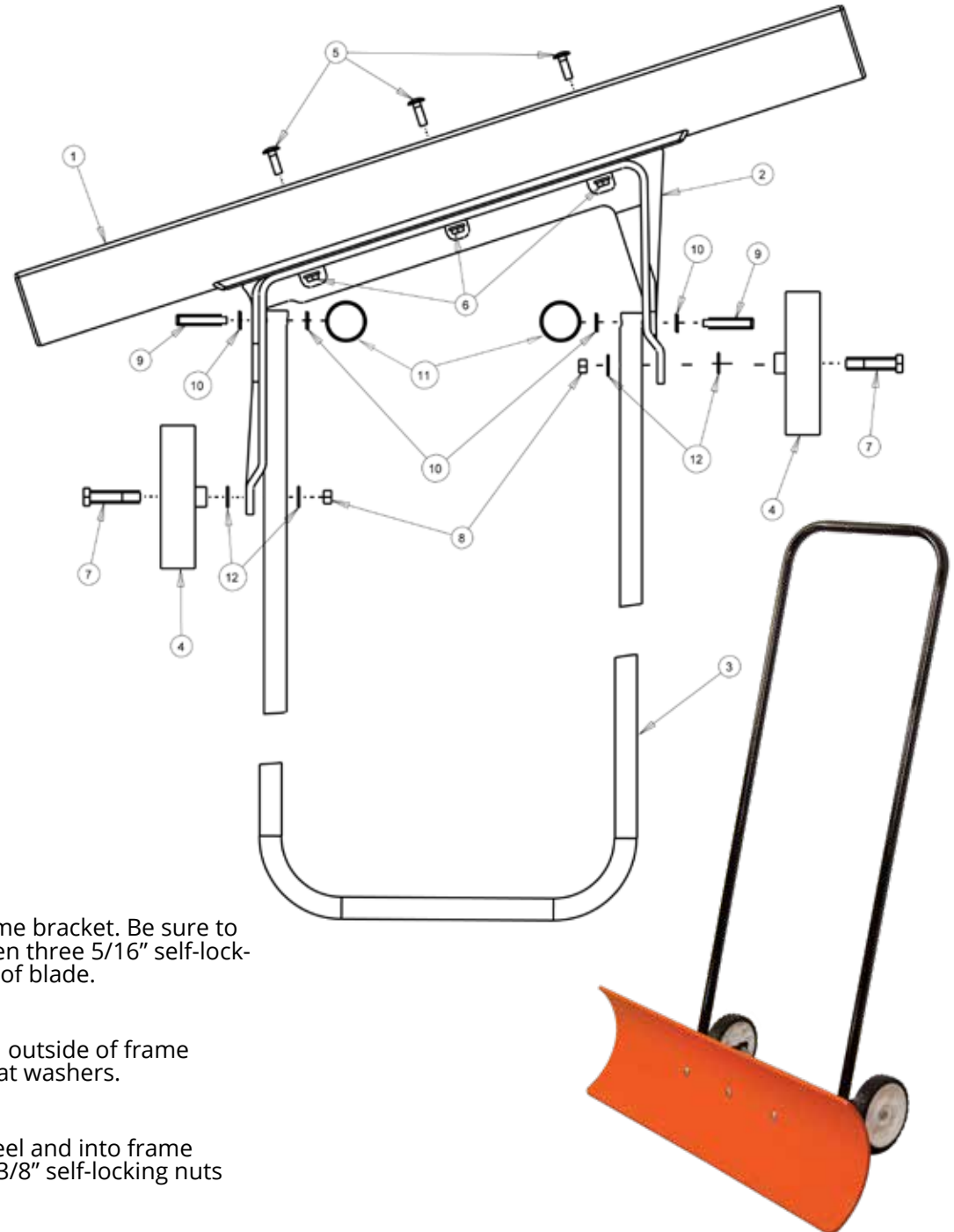

A336P - A.M. LEONARD SNOMOVER™ INSTRUCTIONS

PARTS LIST

Part #	Description	Qty	Repl. Item #
1	Blade	1	A336P01
2	Frame Bracket	1	10BRK
3	Handle	1	50HDL
4	Wheel	2	20WHL
5	1" x 5/16" carriage bolts	3	Replacement Hardware Pack #100HDW
6	5/16" self-locking nuts	3	
7	1-1/2" x 1/2" shoulder bolts	2	
8	3/8" self-locking nuts	2	
9	1-1/2" x 5/16" clevis pins	2	
10	1/4" flat washers	4	
11	Split rings	2	
12	5/16" flat washers	4	



TOOLS

9/16" wrench
1/2" wrench
Pliers or small adjustable wrench

ASSEMBLY

Step 1. Attach Blade to Frame Bracket

Insert three 1" x 5/16" carriage bolts through face of blade into frame bracket. Be sure to align square portion of bolt head with square holes in blade. Tighten three 5/16" self-locking nuts thoroughly so smooth heads of bolts are embed into face of blade.

Step 2. Attach Handle to Frame Bracket

Insert two 1-1/2" x 5/16" clevis pins and two 5/16" washers through outside of frame bracket and into handle. Secure with two split rings and two 1/4" flat washers.

Step 3. Attach Wheels to Frame Bracket

Insert two 1-1/2" x 1/2" shoulder bolts through outside of each wheel and into frame bracket with a 5/16" flat washer on each side of frame. Attach two 3/8" self-locking nuts and tighten thoroughly.