



SIDE SPREAD CONTROL

SIDESPREAD CONTROL™

Patent U.S. 10,993,368

Your EarthWay spreader includes a patented feature to prevent fertilizer from being spread to the left side. To activate this feature, slide the lever below the hopper to the back (if standing behind the spreader) and position the left wheel 6"-12" from your sidewalk or border. This will not waste fertilizer like competitor designs that leave 7X the fertilizer inside the wheels from blocking material leaving the impeller.

PRIOR TO ASSEMBLY, YOU WILL NEED:

7/16" Wrench

Ratchet

7/16" Socket Pliers

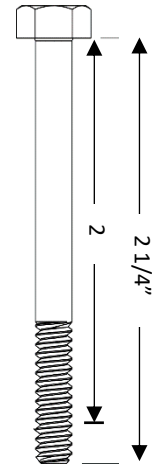

SPREADER RATE SETTINGS

LBS PER 1000 SQUARE FEET	GRASS SEED	FERTILIZER SGN 240 (3/32")	SAND SGN 150 (1/16")
1 LB		9	7
2 LB	14	13	10
3 LB	16	16	13
4 LB	18	20	14
5 LB	20	22	16
8 LB		28	22

HELPFUL HINTS

- ☑ Read the directions before assembly.
- ☑ If your spreader does not spread evenly, be sure "FRONT" on the GEARBOX points to the front of the spreader. **The impeller must turn clockwise when pushing forward.** Reversing the GEARBOX during assembly will cause issues.
- ☑ Your spreader is calibrated for three miles per hour, which is a brisk walking speed. Slower or faster speeds will change the spread pattern. Wet fertilizer will also change the spread pattern and flow rate. **Do not use powdered materials as it will damage the gearbox.**
- ☑ Gears are permanently lubricated at the factory. Do not open the GEARBOX or dirt may enter.

SPREADER ASSEMBLY INSTRUCTIONS

Step 1: Remove the spreader and parts from the carton and arrange on the floor.

Step 2: Install the bearing into the LOWER HANDLES. **Note:** Notch on BEARINGS and slot in the LOWER HANDLES that the bearing fits into. BEARINGS must go through flat side of LOWER HANDLE (from the outside to the inside).

SLIDE AXLE BUSHING over AXLE and into AXLE BEARING to both sides as shown.

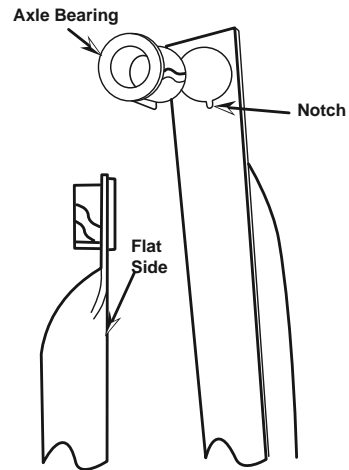

Step 3: Install DRIVE WHEEL onto the AXLE and align with the Cotter Pin hole nearest to the LOWER HANDLES as shown. Insert 2" Cotter Pin through WHEEL and through AXLE. Bend with pliers to prevent pin from falling out.

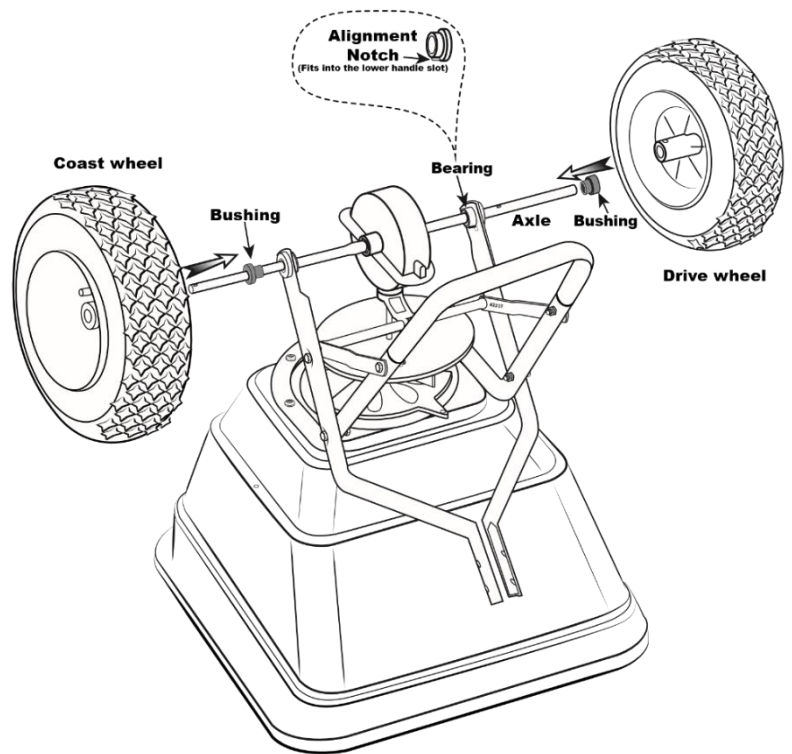

Step 4: Install COAST WHEEL onto the AXLE fully, then using outside Cotter Pin hole, insert 1" Cotter Pin through AXLE (not thru the wheel). Bend with pliers to prevent pin from falling out.

****Note:** newer units have been changed to utilize a spring clip (part number 33115) for the 2" cotter pin and a hog ring (part number 33113) for the 1" cotter pin.**

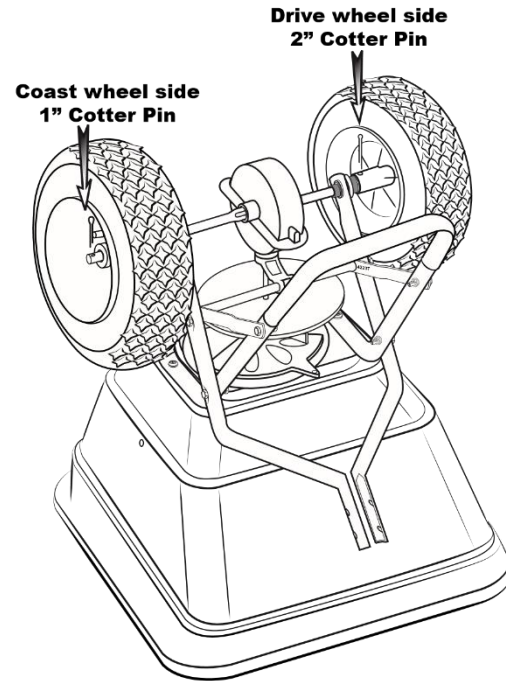

Step 5: Now remove the PIVOT BRACKET from THE LOWER HANDLES. Keep the 1/4 -20 x 2" bolts and locknuts for use in reinstallation.

Step 6: Install HANDLE SHAFT INTO LOWER HANDLES and then reattach the PIVOT BRACKET assembly as shown onto the LOWER HANDLES using two 1/4 -20 x 2" bolts and locknuts. **TIGHTEN BOLTS AND NUTS NOW.**

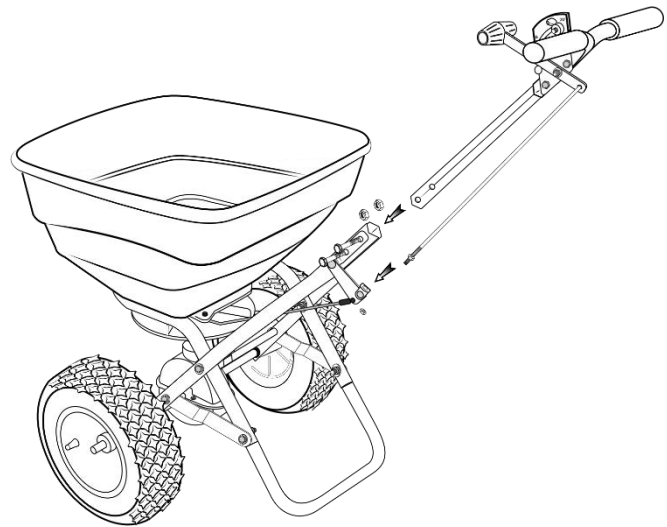

Step 7: Remove one 1/4-20 Hex Nut from the CONTROL ROD. Next, push LEVER forward to setting "0" to help align the CONTROL ROD with hole in PIVOT BRACKET, pull LEVER backward to insert CONTROL ROD through hole in PIVOT BRACKET. Now install 1/4-20 regular nut on to CONTROL ROD.

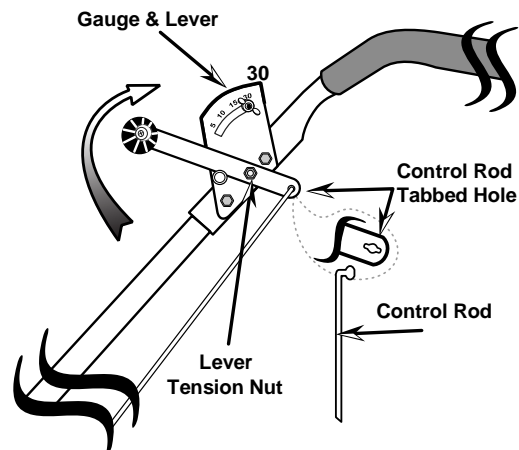

Step 8: Insert the PIVOT ROD into the ROD CLIP that is installed in the PIVOT BRACKET. **Note:** Make sure to ensure that the ROD CLIP is installed as shown to the right.

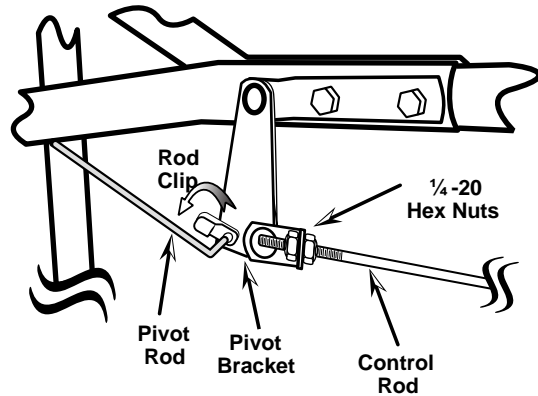

Step 9: **Note:** Before installing GAUGE and UPPER HANDLES to HANDLE SHAFT, UPPER HANDLES feature two positions for operator's comfort.

If operator chooses upper position, use HANDLE SPACER in hole nearest to HANDLE GRIPS.

Insert 2" bolt through UPPER HANDLE, then through HANDLE SPACER through other UPPER HANDLE and secure with locknut. **DO NOT TIGHTEN LOCKNUT YET. TIGHTEN THIS NUT LAST.**

Now slide the UPPER HANDLE assembly over the HANDLE SHAFT (*on the end with the bolt holes closer to the end*). Install GAUGE & LEVER using (2) 2" bolts. Be sure GAUGE is on left hand side. Tighten locknuts to GAUGE first.

TIGHTEN ALL HARDWARE NOW

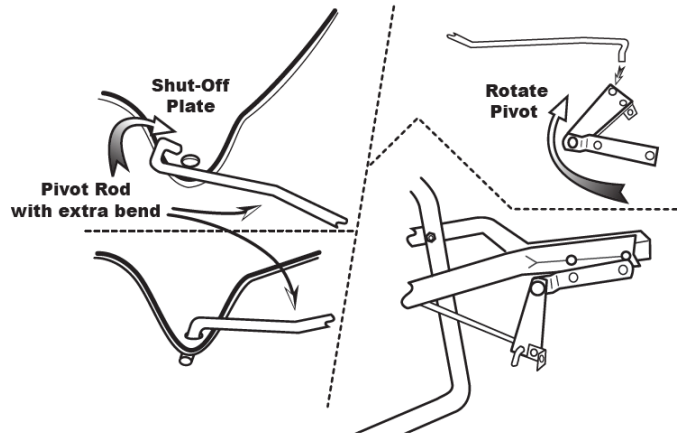

Step 10: Insert PIVOT ROD into SHUT-OFF PLATE as shown. Turn to lock in place.

Tighten ALL hardware then insert other end of PIVOT ROD into PIVOT AND BRACKET assembly as shown. Turn to lock in place.

Step 11: Tighten ALL hardware then insert other end of PIVOT ROD into PIVOT AND BRACKET assembly as shown. Turn to lock in place.

Step 12: Install HANDLE SHAFT to LOWER HANDLES and PIVOT & BRACKET assembly as shown. Using 2" bolts and locknuts. **TIGHTEN BOLTS AND NUTS NOW.**

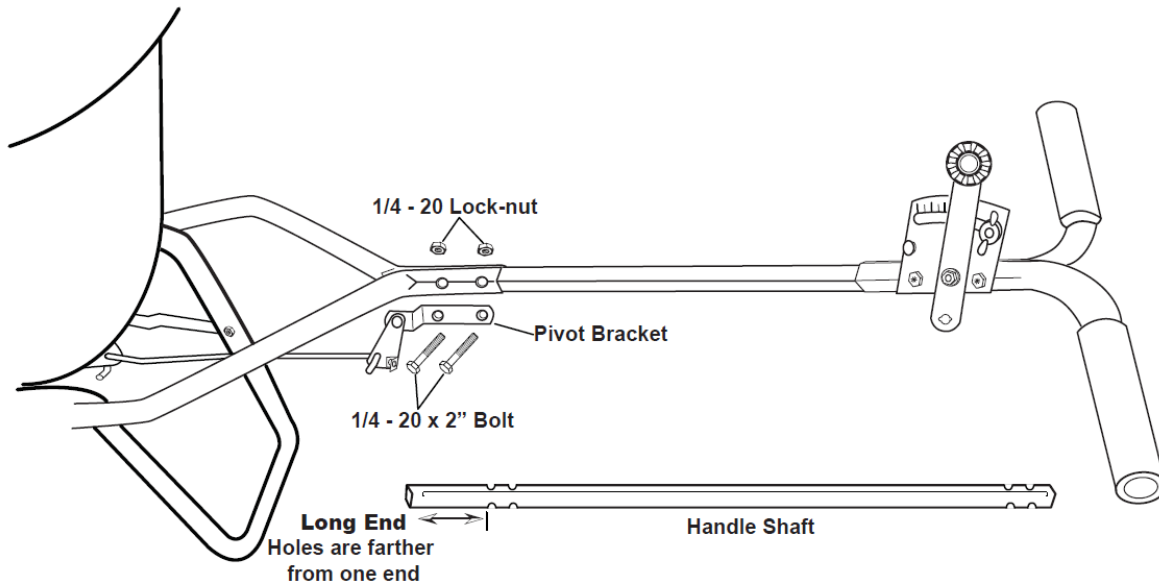

TO COMPLETE ASSEMBLY

Install AGITATOR, bend the AGITATOR up slightly to prevent contact with the STANDARD-OUTPUT tray, and install debris screen. Press over 1/4 turn fasteners to secure

This only applies to the RED 3-hole drop STANDARD-OUTPUT Trays.

The HIGH-OUTPUT (Blue) and LOW-OUTPUT (Black) Trays do not use the AGITATOR or DEBRIS SCREEN shown below.

TRAY INSTALLATION

Step 1: Ensure the hopper is clean and there is no debris trapped around the tray mounting area.

Step 2: Install the PIVOT ROD CLIP ① into the Shut-off of the selected TRAY ③.

Step 3: Insert the PIVOT ROD ② into the CLIP ①. *TIP:* The CLIP ① may have a burr in the hole, use a Phillips screwdriver to remove the burr. See ④ to make installing the PIVOT ROD ② easier. Pliers may be required to help squeeze the PIVOT ROD ② into the CLIP ①.

Step 4: When the ROD ② is secure inside the CLIP ① push the free end of the CLIP ① over the PIVOT ROD ② to firmly secure the rod to the clip.

Step 5: Install the TRAY ③ from the top downwards into the hopper (see figure ⑤) positioning the center hole of the tray over the PINION SHAFT from the gear box with the PIVOT ROD through the bottom of the hopper and facing toward the spreader's handlebar. For ease of locating into position the shut-off of the chosen tray is best in the open position, with the exception of the red STANDARD-OUTPUT TRAY where the two adjustable throwing ports are best in the closed position.

NOTE: The gearbox can be moved along the axle to ease aligning of the tray hole and the PINION SHAFT.

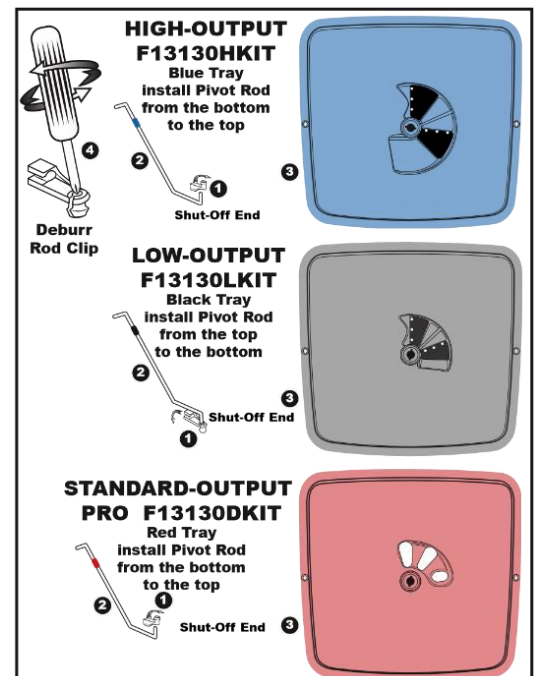

Step 6: Once the tray is in place check that the tray is sealed and flush against the hopper sides. To check if the tray is properly located, push the tray edges downwards.

Step 7: Install the two quarter turn fasteners (see figure 6) through the two exposed tray holes and push down and twist a quarter turn to secure.

Step 8: Lastly, connect the free end of the PIVOT ROD 2 into the PIVOT linkage at the bottom of the CONTROL ROD. Position the CLIP 1 into the free hole and push the PIVOT ROD 2 into the clip. **TIP:** The CLIP 1 may have a burr in the hole, use a Phillips screwdriver to remove the burr (see figure 4).

Step 9: When the PIVOT ROD 2 is positioned inside the CLIP 1 push the free end of the CLIP 1 over the PIVOT ROD 2 to firmly secure the rod and the clip together.

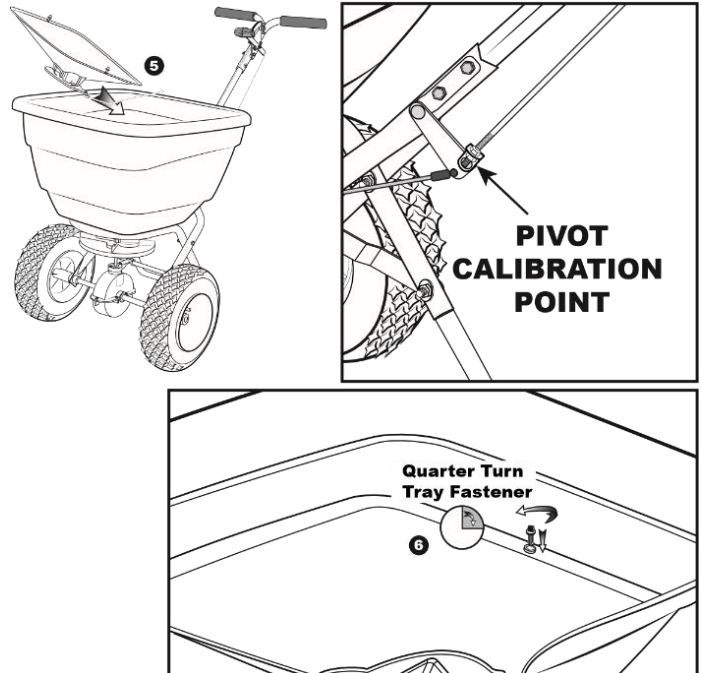

SPREADER CALIBRATION INSTRUCTIONS

HIGH-OUTPUT and LOW-OUTPUT TRAY:

Make sure the drop holes in the bottom of the hopper are **FULLY CLOSED** when the RATE CONTROL LEVER is resting on the Stop #0.

If the shut-off is not set correctly, please adjust CONTROL ROD at the PIVOT to position the shut-off for **FULLY CLOSED** at position at the Stop #0 on the RATE CONTROL LEVER. **As a side note, the HIGH-OUTPUT and LOW-OUTPUT TRAYS do not include or use a horizontal agitator.**

Calibration Adjustment

Review the CONTROL LEVER position to confirm that it is set so that the forward edge of the LEVER is resting at #0 (the stop) and the drop holes are closed. Move the spreader back & forth to ensure that the cam is positioned to allow the oscillating shut-off to close fully. If the shut-off is not properly positioned, you will need to adjust the CONTROL ROD at the PIVOT BRACKET shown below.

TIP: If your shut-off is not able to **CLOSE** fully, loosen the top nut a few turns, then tighten the lower nut so that it allows you to push the **shut-off fully closed**. Next, tighten each nut so that they contact the PIVOT BRACKET without moving it, and then carefully tighten each nut fully so they do not loosen during use. Recheck adjustment as outlined above.

STANDARD-OUTPUT TRAY:

Make sure the drop holes in the bottom of the hopper are **FULLY OPEN** when the RATE CONTROL HANDLE is on #30. If the shut-off is not set correctly, please adjust CONTROL ROD at the PIVOT to position the shut-off for **FULLY OPEN** hopper position at #30 on the RATE CONTROL LEVER. Install the horizontal AGITATOR through the PINION SHAFT in the hopper bottom. Finally, install the DEBRIS SCREEN onto the Quarter-turn fasteners and push down to snap and secure.

Review the CONTROL LEVER position to confirm that it is set so that the rear edge of the LEVER is resting at #30 (the stop) and the drop holes are open. If the shut-off is not properly positioned, you will need to adjust the CONTROL ROD at the PIVOT BRACKET shown below. **TIP:** If your shut-off is not able to **OPEN** fully, loosen the bottom nut a few turns, then tighten the upper nut so that it allows you to push the **shut-off fully open**. Next, tighten each nut so that they contact the PIVOT BRACKET without moving it.

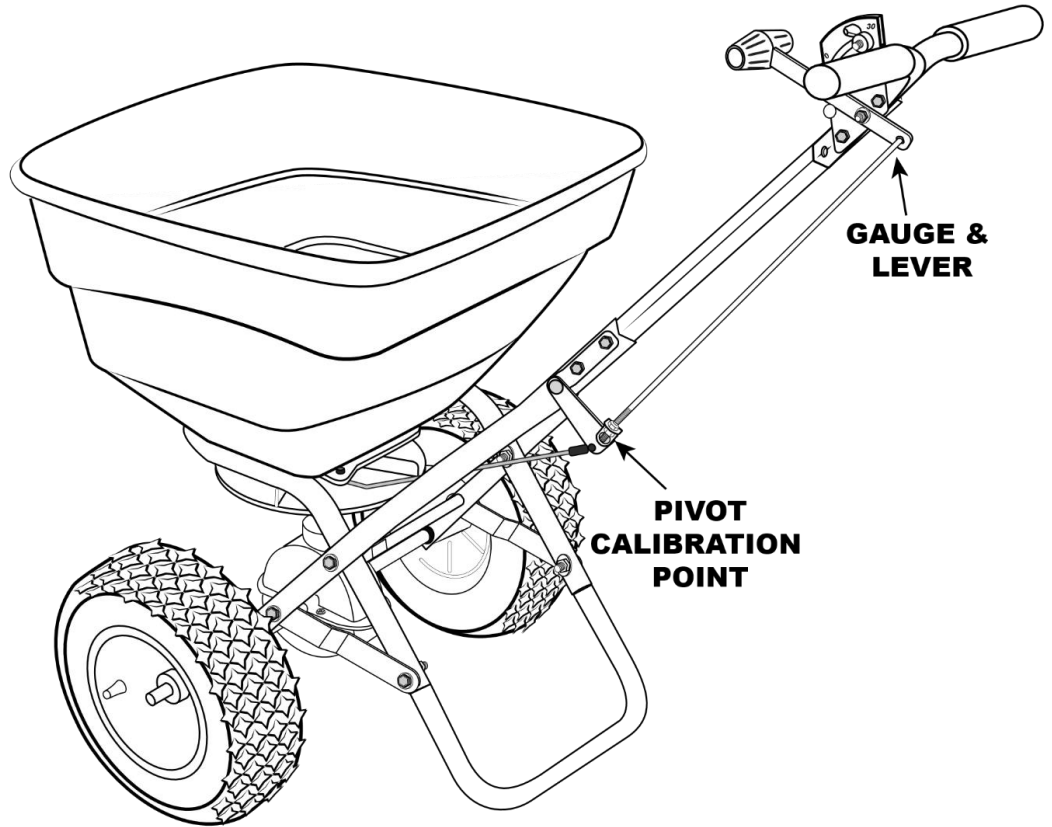

Then, if the CONTROL LEVER does not stay in position causing the setting rate to change without your intervention, you can adjust the drag on the LEVER by tightening or loosening the nut shown to the right until the drag is appropriate.



OPERATING INSTRUCTIONS

- ☑ Obtain proper setting for material to be used from the enclosed SETTING MATRIX included with this spreader, or from our web site under the MANUALS SECTION.
- ☑ Set stop bolt on rate gauge assembly to the proper rate setting.
- ☑ While pushing spreader forward, pull control lever back to stop bolt, to stop spreading, push lever forward to close flow holes before you stop moving.
- ☑ When finished, empty any remaining material from hopper, rinse spreader, apply coating of light oil to all metal parts. The gearbox is sealed and is factory lubricated.

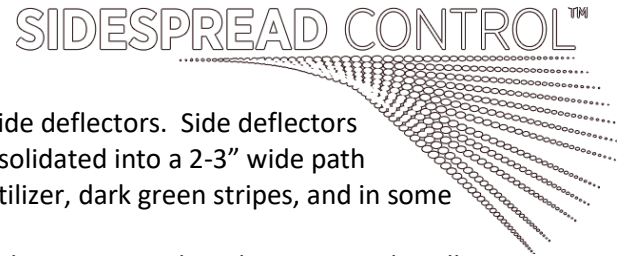

The **SideSpread-Control** is a patented innovation that is superior to side deflectors. Side deflectors block material leaving the impeller. This blocked material is now consolidated into a 2-3" wide path on the left inside wheel of your spreader. This equates to wasted fertilizer, dark green stripes, and in some cases this extra fertilizer (seven times) will damage the lawn.

SideSpread-Control maintains the correct application rate while not placing material on driveways, sidewalks, flowerbeds, or worse, the storm drains in your street. This saves you money and keeps you from damaging your lawn.

To engage **SideSpread-Control**:

- 1) Locate the lever on under the right side of the hopper.
- 2) Slide the control lever from the front to the back.
- 3) Position the left wheel of your spreader 6"–12" from the sidewalk, flowerbed, or driveway and spread as normal.
- 4) When you have completed this spreading pass, close the control lever to "0", and then open the **SideSpread-Control™** by sliding the control lever from back to the front, for a **FULL**, 180 degree spread pattern.

CUSTOMER SERVICE

SUPPORT@EARTHWAY.COM | www.EARTHWAY.com | 1009 Maple Street, Bristol, IN 46507

SCHEDULE A - WARRANTY TERMS

Limited Warranty

EarthWay Products, Inc. provides this limited warranty that this product is free of defects in original workmanship and materials for a period of one year to the end user with the original purchase receipt. If a manufacturing non-conformance is found, EarthWay Products, Inc. at its discretion will repair or replace the part(s)/product at no charge provided the failure is not the result of incorrect installation, mishandling, misuse, tampering, improper storage, or normal wear and tear as determined by EarthWay. Due to the corrosive nature of most fertilizers and ice melt products, EarthWay Products, Inc. makes no warranty against and specifically excludes part(s) or product degradation or failure due to corrosion or its effects.

EarthWay at its discretion may require that the part(s) or product be returned along with the original purchase receipt for examination and compliance with the terms of this limited warranty. Do not return any product without first receiving authorization from EarthWay Products, Inc. IN NO EVENT SHALL EITHER PARTY BE LIABLE TO THE OTHER FOR SPECIAL, INDIRECT, INCIDENTAL, OR CONSEQUENTIAL DAMAGES, EVEN IF SUCH PARTY SHALL HAVE BEEN ADVISED OF THE POSSIBILITY OF THE SAME.

To seek remedy under this limited warranty, contact EarthWay Products, Inc. at support@earthway.com or write to EarthWay Products, Inc. 1009 Maple Street, Bristol, IN 46507, and describe the nature of the manufacturing defect. SPECIFIC LIMITATIONS: This limited warranty covers only the part(s) or product; any labor charges associated with the repair or replacement of non-conformances are specifically excluded.

The above-listed warranty procedure is a condition precedent to bringing any legal action to enforce this limited warranty. Any action to enforce any portion of this limited warranty must be commenced within ninety days after the expiration of the limited warranty coverage period. Any performance of repairs will not suspend this limitation period from expiring unless state law provides otherwise. Any performance of repairs after the limited warranty coverage period has expired, or performance of repairs regarding anything excluded from coverage under this limited warranty shall be considered "goodwill" repairs, and they will not change the express terms of this limited warranty or extend the limited warranty coverage period.

Exclusive jurisdiction for deciding legal disputes relating to alleged breach of warranty or representations of any nature relating to this limited warranty must be filed in the courts of Elkhart County within the State of Indiana. Any and all claims, controversies, and causes of action arising out of or relating to this limited warranty, whether sounding in contract, tort, or statute, will be governed by the laws of the State of Indiana, without giving effect to any choice or conflict of law provision or rule.

NO OTHER WARRANTY, EXPRESS, IMPLIED, OR STATUTORY, SHALL APPLY, INCLUDING, BUT NOT LIMITED TO, ANY IMPLIED WARRANTY OF MERCHANTABILITY, APPLICATION, OR FITNESS FOR A PARTICULAR PURPOSE, OR ANY OTHER WARRANTY OBLIGATION ON THE PART EARTHWAY, AND ALL SUCH WARRANTIES ARE EXPRESSLY DISCLAIMED. In the event that applicable law prevents the disclaimer of any implied warranties, then such implied warranty shall be limited to the fullest extent permitted by law. Without limiting the foregoing, if applicable prevents the disclaimer of any such implied warranties, this limited warranty limits the period of time in which a claim for breach of implied warranties, including but not limited to the implied warranty of merchantability or fitness for a particular purpose, may be filed. In such event, any claim for breach of implied warranty must be brought before the expiration of this express limited warranty's one-year term.

HOW TO ORDER SPARE PARTS – CALL or EMAIL:

TURF DEPOT 800-305-9255 or earthway@turfdepot.com

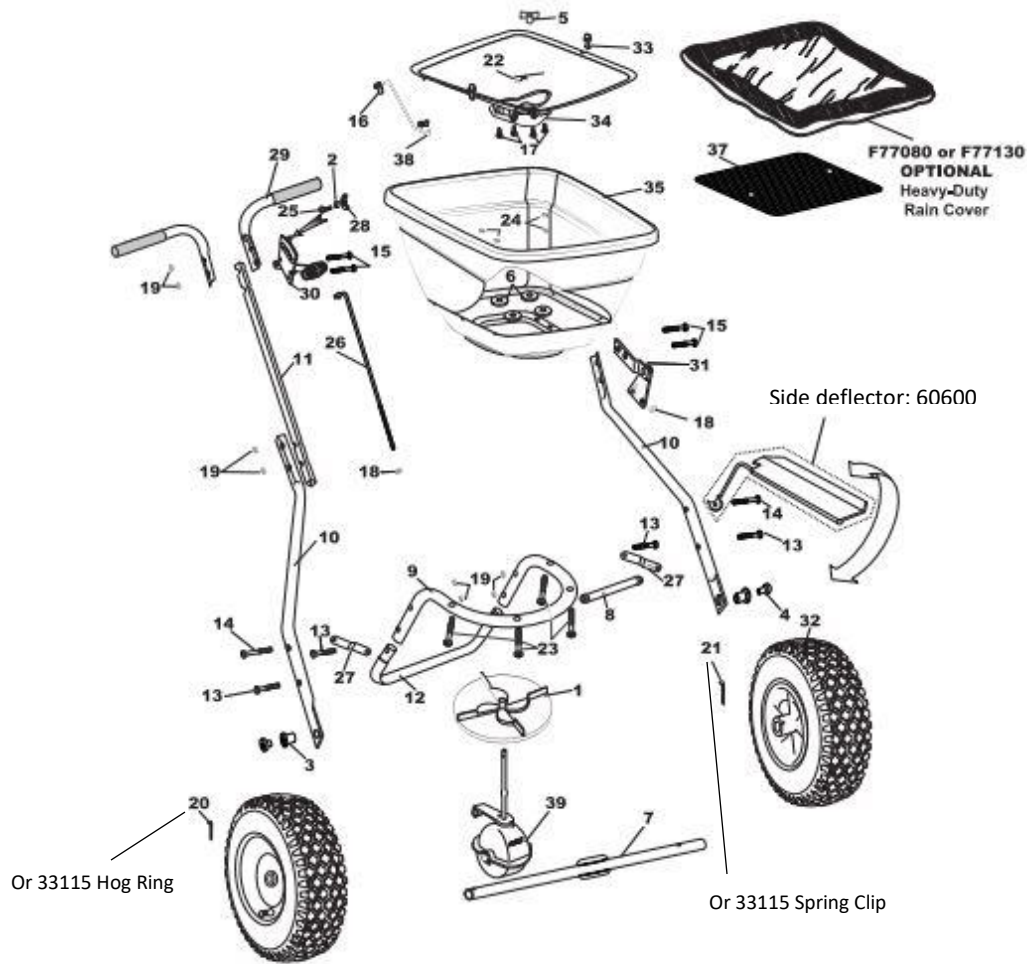

Key #	Part #	Description	Key #	Part #	Description
1	12110	IMPELLER 9" ROUND DISHED	23	36214	1/4-20 X 1 1/2" PHPMS S.S.
2	12147	SPACER (PIVOT LINK)	24	36300	1/4-20 NYLON INSERT LOCKNUT S.S.
3	12148	AXLE BEARING	25	37100	1/4-20 X 1" CARRIAGE BOLT ZINC
4	12152	AXLE BUSHING	26	42256	CONTROL ROD
5	12209	HOPPER BUSHING	27	44249	FRAME BRACE
6	43020	BACKPLATE WASHER (FOR F130)	28	60027	WING NUT ASSEMBLY BLACK
7	24500	AXLE	29	60175-SS	UPPER HANDLE SQUARE STAINLESS W/GRIP ea
8	25228	CROSS BRACE 11.25"	30	60298	GAUGE & LEVER ASSEMBLY
9	24111	FRAME	31	60300	PIVOT & BRACKET ASSEMBLY
10	25222-SS	LOWER HANDLE	32	70138	PNEUMATIC DRIVE WHEEL STUD
11	25223-SS	HANDLE SHAFT	33	F12135	1/4 TURN FASTENER FLEX SELECT
12	25723-SS	FRAME FOOT SS	34	F12219	STANDARD OUTPUT FLEX-SELECT SHUTOFF
13	36200	1/4-20 X 1 1/2" HHCS S.S.	35	F13105	FLEX-SELECT 80# HOPPER / F13106 FLEX-SELECT 130# HOPPER
14	36205	1/4-20 X 2 1/4" HHCS S.S.	36	F13130	STANDARD OUTPUT FLEX-SELECT TRAY KIT
15	36216	1/4-20 X 2" HHCS S.S.	37	F40003	SQUARE SCREEN FLEX-SELECT-included with Standard Trays only
16	31127	ROD CLIP (Flex-Select)	38	F44251	PIVOT ROD STD OUTPUT FLEX-SELECT
17	31138	#8 X 3/8" PMT #8 HD COARSE BLACK	39	F60333	GEAR BOX ASSEMBLY FLEX-SELECT
18	32100	1/4-20 HEX NUT ZINC			
19	36300	1/4-20 NYLON INS LOCKNUT S.S.	Optional	60600	SIDE DEFLECTOR
20	33115	Spring Clip	Optional		HEAVY DUTY RAIN COVER (F77080 for F80 / F77130 FOR F130)
21	33113	Hog Ring			
22	33117	AGITATOR			